



## 20a St. Leonards Avenue Chatham, Kent, ME4 6HL

Greenleaf are delighted to offer to let this one bedroom property located just off of Maidstone Road, Chatham. Offering an entrance porch, reception room, kitchen with access to rear garden and staircase up to the bedroom and bathroom. Located close to transport links and local amenities. With gas central heating and double glazed. Available now, also benefitting from a single GARAGE, ideal for storage, bikes etc. Available now.

In order to reserve a property you will be required to pay a holding deposit equivalent to one weeks rent. This will be refunded once checks are complete unless false or misleading information is provided, a Right to Rent check fails or you withdraw from the property. It can, with agreement be put towards the first months rent due along with the five week deposit. If you require any further information just give the team a call or email on [info@greenleaf-property.co.uk](mailto:info@greenleaf-property.co.uk).

Greenleaf are a member of the PRS (property redress scheme) membership number: PRS003992  
Greenleaf Property Services Ltd have client money protection – property mark - membership – C0128543

**£900 PCM**

# 20a St. Leonards Avenue

Chatham, Kent, ME4 6HL



- ONE BEDROOM PROPERTY WITH GARAGE
- GAS CENTRAL HEATING
- COUNCIL TAX BAND A
- IDEAL FOR SINGLE OCCUPANT
- 1 WEEK HOLDING DEPOSIT £207.69 (RENTX12/52)
- AVAILABLE NOW
- CLOSE TO ALL AMENITIES
- 5 WEEK DEPOSIT £1038.46 (RENT X12 /52 X5)

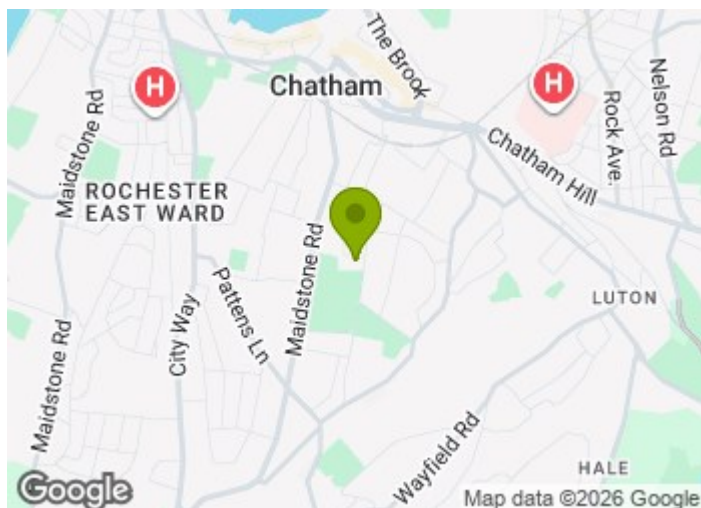

[Directions](#)

Tel: 01634730672



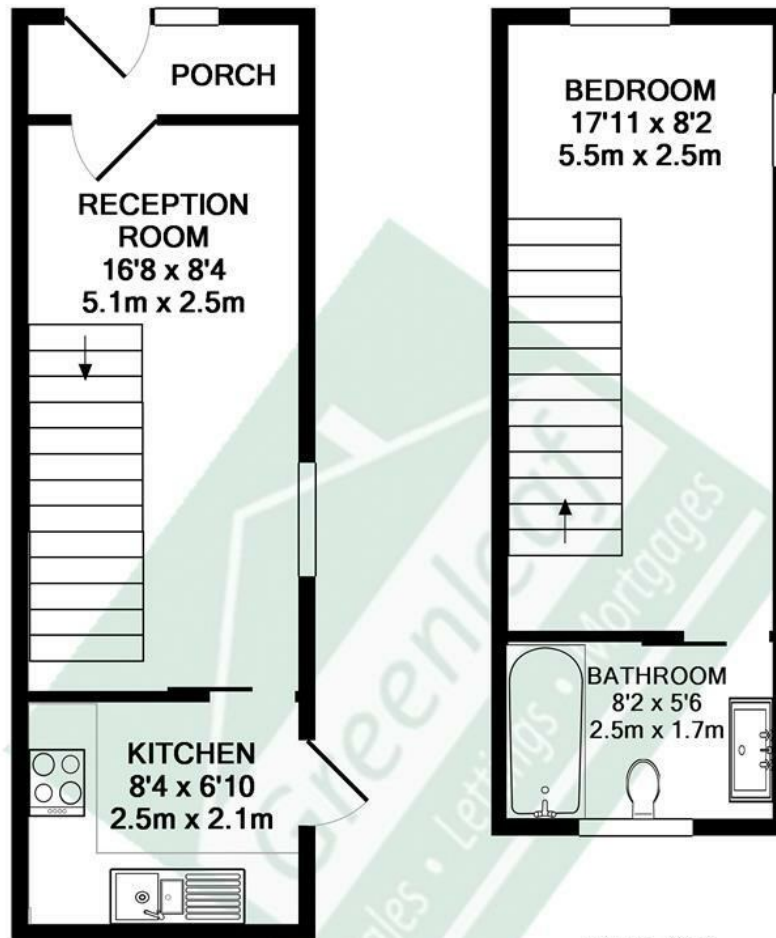

GROUND FLOOR  
 APPROX. FLOOR  
 AREA 220 SQ.FT.  
 (20.4 SQ.M.)

1ST FLOOR  
 APPROX. FLOOR  
 AREA 191 SQ.FT.  
 (17.7 SQ.M.)

TOTAL APPROX. FLOOR AREA 410 SQ.FT. (38.1 SQ.M.)

Whilst every attempt has been made to ensure the accuracy of the floor plan contained here, measurements of doors, windows, rooms and any other items are approximate and no responsibility is taken for any error, omission, or mis-statement. This plan is for illustrative purposes only and should be used as such by any prospective purchaser. The services, systems and appliances shown have not been tested and no guarantee as to their operability or efficiency can be given

Made with Metropix ©2018

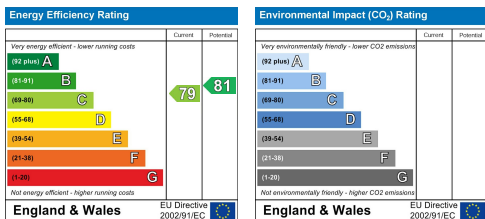

Greenleaf Property Services is a trading name of Greenleaf Property Services Limited.  
 Registered Office: 281 Wilson Avenue, Rochester Kent ME1 2SS  
 Registered No: 06222461 England. VAT No: 908929091

These particulars, whilst believed to be accurate are set out as a general outline only for guidance and do not constitute any part of an offer or contract. Intending purchasers should not rely on them as statements of representation of fact, but must satisfy themselves by inspection or otherwise as to their accuracy. No person in this firm's employment has the authority to make or give any representation or warranty in respect of the property.